

Description

The BADD Sim Kit is a single-use training tool designed to mimic the BADD single kits for Anthrax, Ricin Botulinum, Y. pestis, SEB and others

Important Information

Please review entire kit instructions prior to use. Use only the materials supplied in this kit!

Always use proper PPE or refer to your organization's written protocol.

Humidity levels above 80% can slow results. Do not use in direct rain.

Device works best in temperatures between 38 and 90 degrees fahrenheit or 4 to 32 degrees celsius.

Maximum temperature range: 34 to 120 degrees fahrenheit 1 to 49 degrees celsius.

DO NOT open inner white pouch until you are ready to perform the evaluation.

Contact Us

Advnt Biotechnologies LLC USA
Toll free 888-223-3269
Emergency Information 24/7
602-803-1535

Technical information can also be found at www.advnt.org

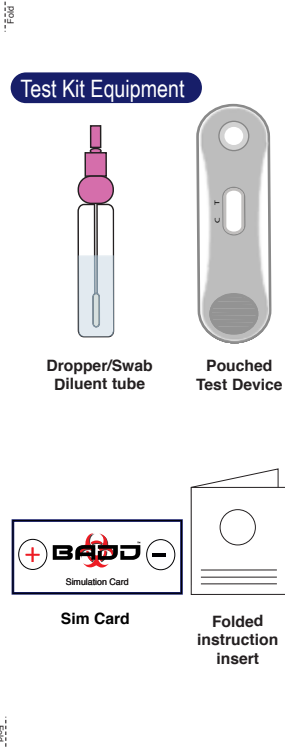

1

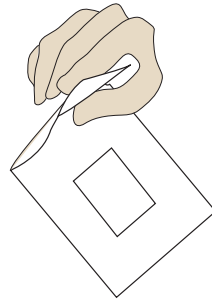

Tear open the inner white pouch to remove the test device. Place the device and the diluent tube on a flat, horizontal surface in front of you.

2

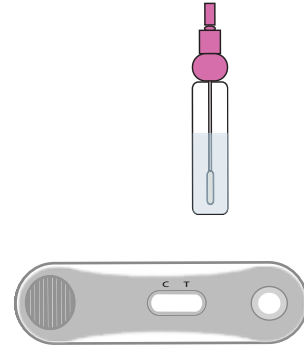

The test device should be placed in front of you with the "C" and "T" towards the top and the small round sample well to your right as shown above.

3

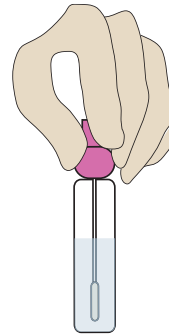

Unscrew the cap from the diluent tube. While removing the swab, rub the foam tip against the inside walls to extract excess liquid then remove the swab completely.

4

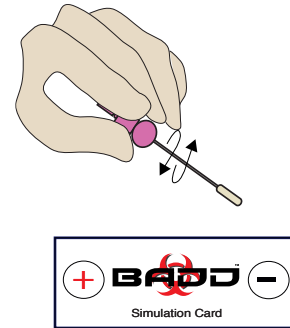

Using the "SIM" card, select either the positive or negative sign depending on the results you want to achieve. Rub the swab with a twisting motion over the + or - sign for 5-10 seconds.

5

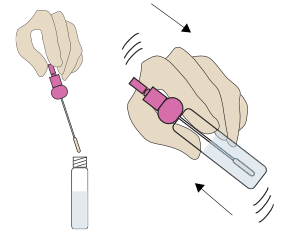

Return the swab back to the diluent tube and tighten the cap. Gently shake the tube for approximately 5 seconds.

MOVE TO STEP 6 ON THE BACK PAGE

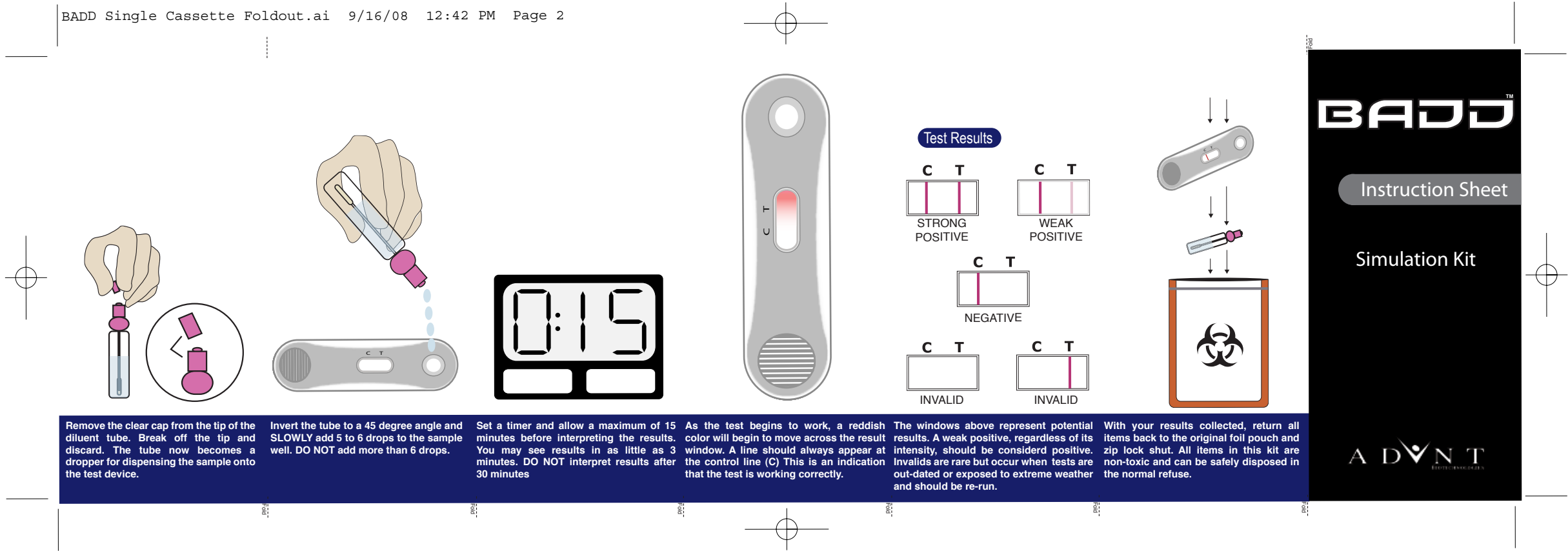

Remove the clear cap from the tip of the diluent tube. Break off the tip and discard. The tube now becomes a dropper for dispensing the sample onto the test device.

Invert the tube to a 45 degree angle and SLOWLY add 5 to 6 drops to the sample well. DO NOT add more than 6 drops.

Set a timer and allow a maximum of 15 minutes before interpreting the results. You may see results in as little as 3 minutes. DO NOT interpret results after 30 minutes

As the test begins to work, a reddish color will begin to move across the result window. A line should always appear at the control line (C) This is an indication that the test is working correctly.

The windows above represent potential results. A weak positive, regardless of its intensity, should be considered positive. Invalids are rare but occur when tests are out-dated or exposed to extreme weather and should be re-run.

With your results collected, return all items back to the original foil pouch and zip lock shut. All items in this kit are non-toxic and can be safely disposed in the normal refuse.

BADD™

Instruction Sheet

Simulation Kit

A D V N T
EMERGENCY RESPONSE